

200 x 100 x 30 cm*

78.7" x 39.4" x 11.8"

SIMONCLICK PLUS 5/300

5 years
SIMONRACK
GUARANTEE

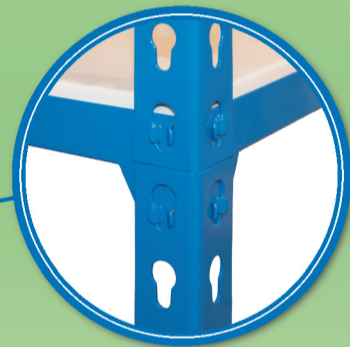

*MEDIDAS EN USO: 1979 x 1011 x 310 mm
USED MEASUREMENTS: 77.91" x 39.80" x 12.21"



Simon
Rack
SINCE 1964 - MANUFACTURER

ESTANTERIAS SIMON S.L. B.50.556.463
PG. ALFAMEN C/ POLIGONO C, N°3
ALFAMEN (ZARAGOZA)



www.simonrack.com



Management System
ISO 9001:2008
www.tuv.com
ID 910504425

INSTRUCTIONS

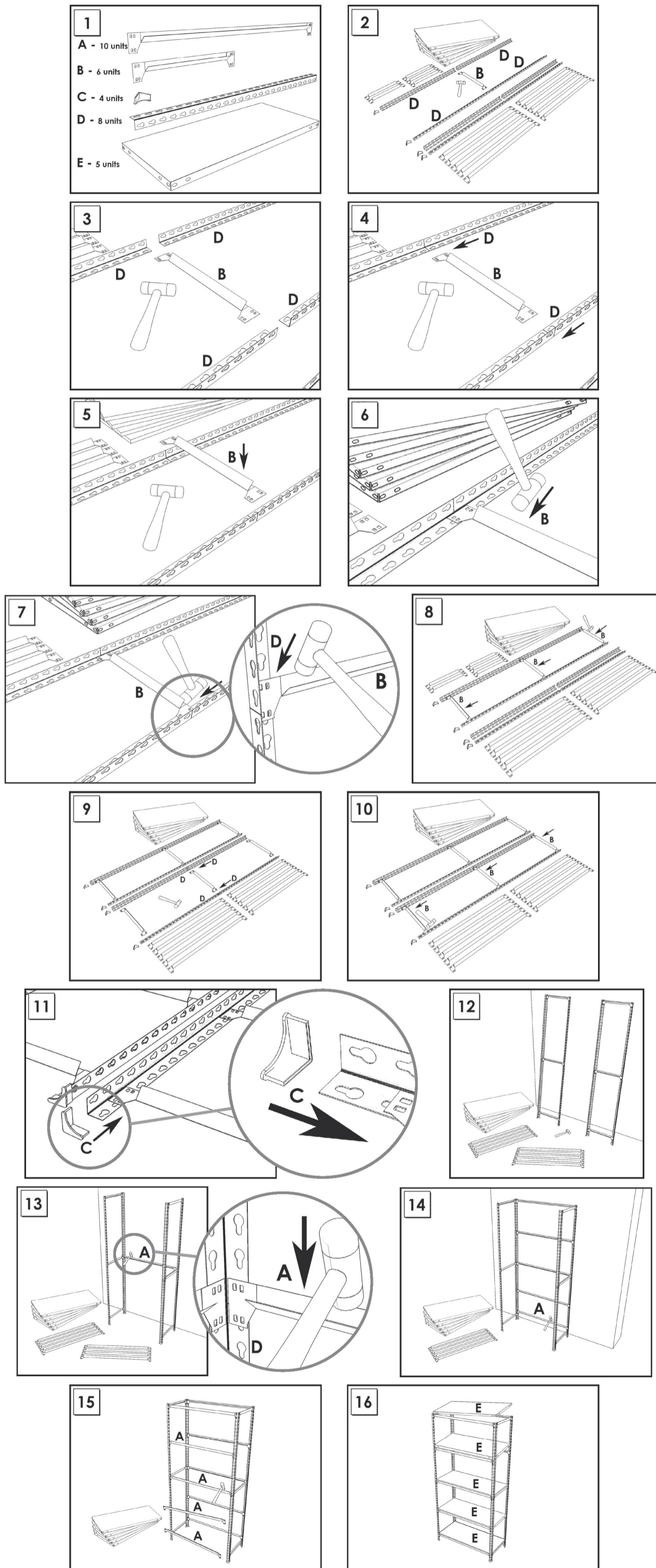

On-line instructions: www.instructionsrack.com/simonclick

SIMONCLASSIC

**BOLTS
SYSTEM**



Up to: **150 Kg**
(331 lb)
Kg/Shelf
Uniformly Distributed Load



SIMONCLICK

**NO BOLTS
SYSTEM**



Up to: **400 Kg**
(882 lb)
Kg/Shelf
Uniformly Distributed Load



SIMONOFFICE

**NO BOLTS
SYSTEM**



Up to: **275 Kg**
(606 lb)
Kg/Shelf
Uniformly Distributed Load



SIMONTALLER

**NO BOLTS
SYSTEM**



Up to: **700 Kg**
(1543 lb)
Kg/Shelf
Uniformly Distributed Load



**BANCOS DE TRABAJO
WORK BENCHES**

Up to: **800 Kg**
(1764 lb)
Kg/Shelf
Uniformly Distributed Load

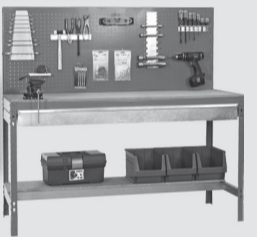

SIMONHOME

Up to: **150 Kg**
(331 lb)
Kg/Shelf
Uniformly Distributed Load



**TAQUILLAS
LOCKER**



SIMONTITÁN

**NO BOLTS
SYSTEM**



Up to: **900 Kg**
(1984 lb)
Kg/Shelf
Uniformly Distributed Load



SIMONINOX

**NO BOLTS
SYSTEM**



SIMONPALET

**NO BOLTS
SYSTEM**



Up to: **4500 Kg**
(9923 lb)
Kg/Shelf
Uniformly Distributed Load



SIMONLEVER

**NO BOLTS
SYSTEM**



**ALTILOS Y PASILLOS ELEVADOS
PLATFORMS AND MEZZANINES**

